

1 Set sliding door fittings **Flatec I**

2 Guide rail

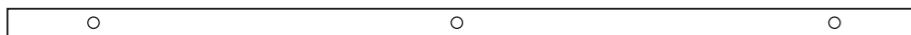

3 Door stoppers

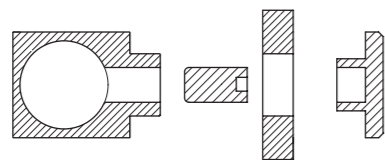

4 Trolley complete

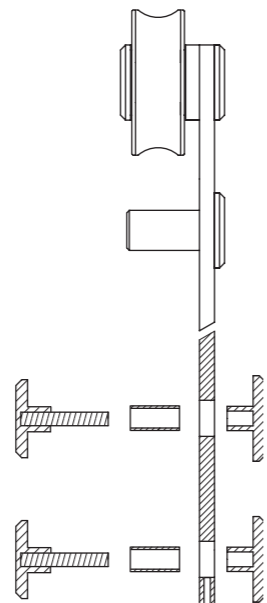

5 Wall fixtures

5/16"-18UNC

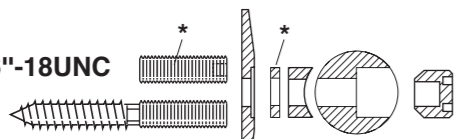

(without screws and dowels, at construction site)
* not included in scope of delivery.

6 Special tool

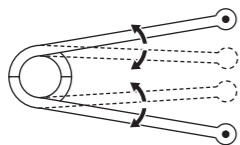

7 Bottom guide

(without screws and dowels, at construction site)

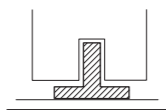

Comply with all general safety regulations when installing the sliding door fittings!

Installation to be completed by qualified licensed contractor.

Be sure to tighten all screw connections one week after starting to use the sliding door fittings!

Never use scouring agents to clean the sliding door fittings; rather use coincommercially available stainless-steel cleaners!



Attention



Screw on



Screw on



Screw on

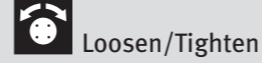

Loosen/Tighten



Install

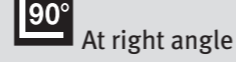

At right angle



Drill



Dowels

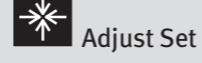

Adjust Set



Level

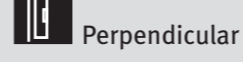

Perpendicular

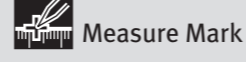

Measure Mark



Visual inspection

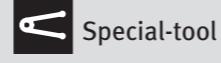

Special-tool

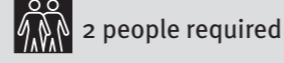

2 people required



Measure

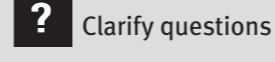

Clarify questions

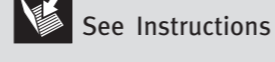

See Instructions



Secure

USU45_Mont_US

Installation instructions

Sliding door fittings Flatec I

for wooden doors (max. 1 3/4" thickness)

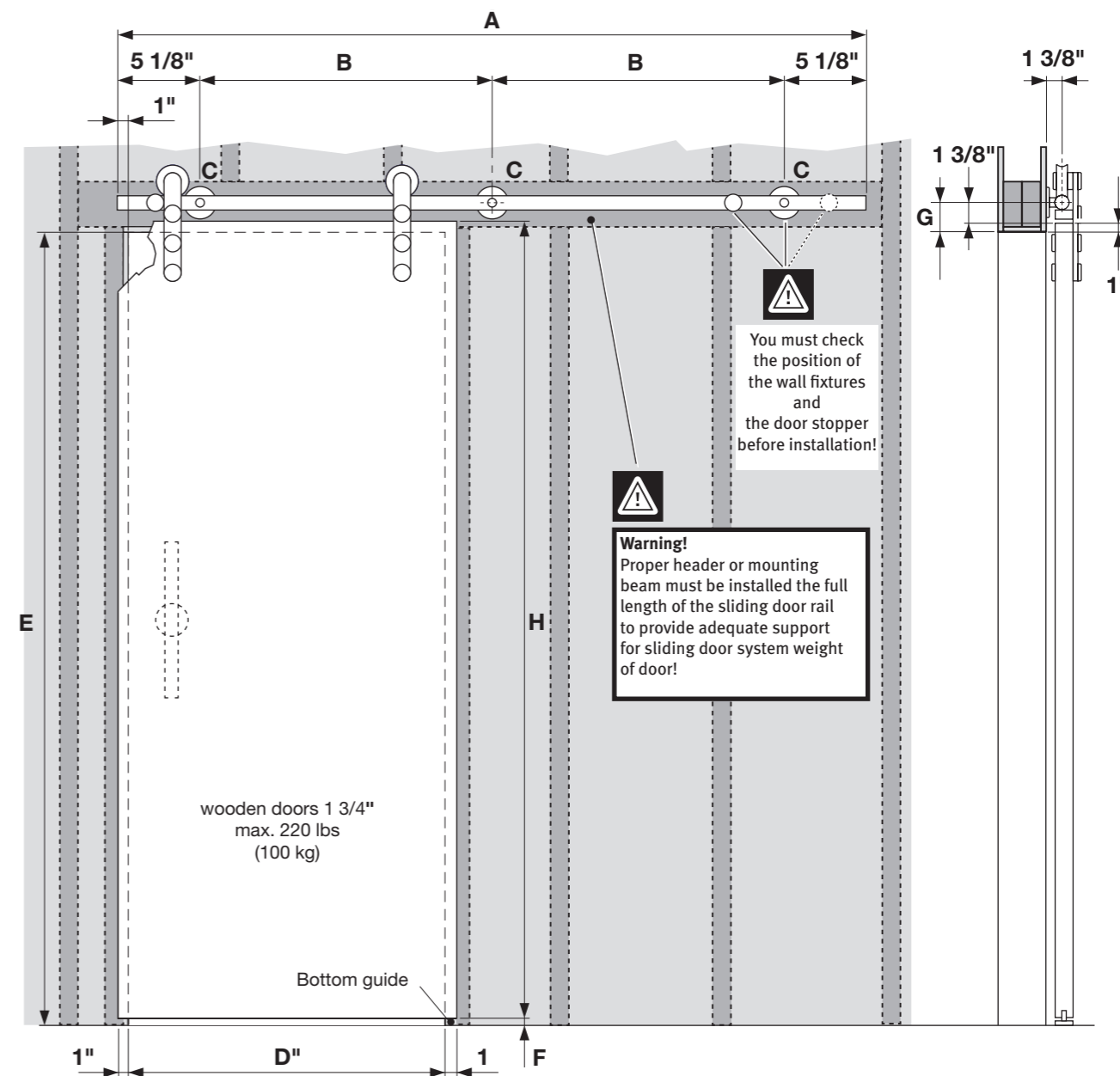

Complete-sets

Set Flatec I Artikel-No.	A inch	B inch	C Each	D inch	E max. inch	F inch	G inch	H max. inch (H=E-F+25)
USU45-1800EF	70 7/8"	30 5/16"	3	29 1/2"-35 7/16"	98 7/16"	1/4"-3/8"	2 3/8"	99 1/8"
USU45-2100EF	82 11/16"	24 1/8"	4	35 13/16"-39 3/8"	98 7/16"	1/4"-3/8"	2 3/8"	99 1/8"
USU45-2300EF	90 9/16"	26 3/4"	4	39 3/4"-44 1/16"	98 7/16"	1/4"-3/8"	2 3/8"	99 1/8"
USU45-2540EF	100"	29 15/16"	4	44 1/2"-49 3/16"	98 7/16"	1/4"-3/8"	2 3/8"	99 1/8"

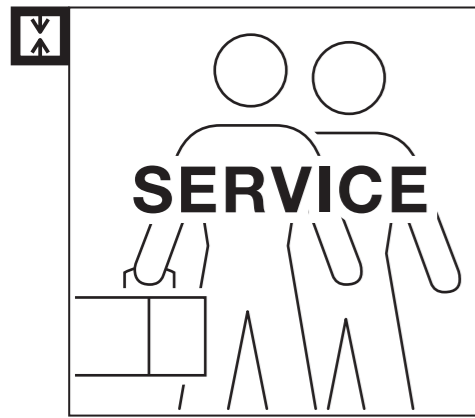

Fig. 1

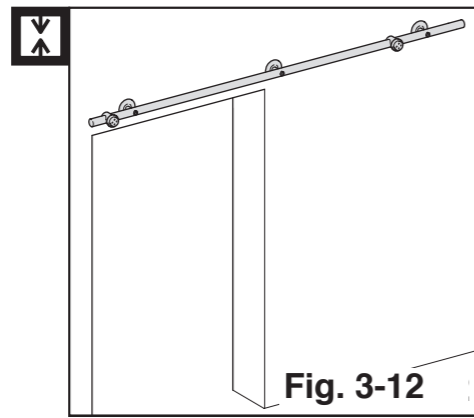

Fig. 2

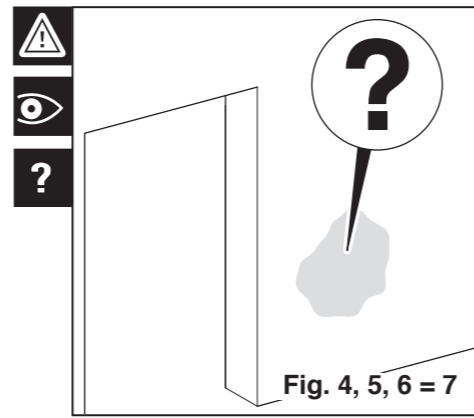

Fig. 3

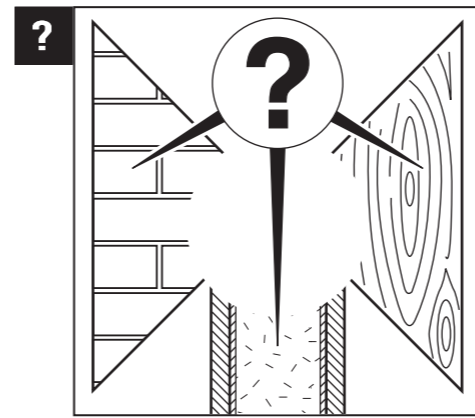

Fig. 4

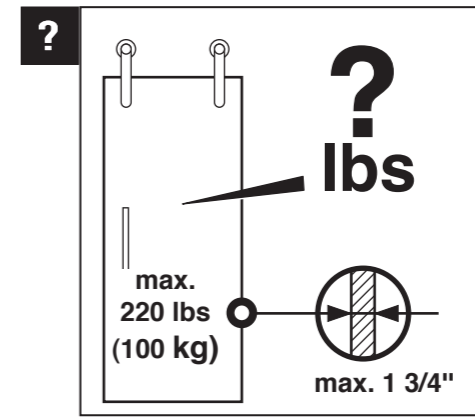

Fig. 5

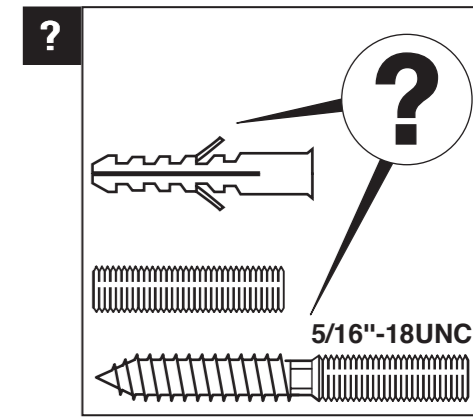

Fig. 6

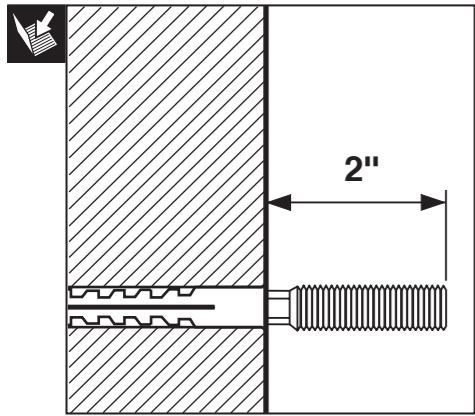

Fig. 7

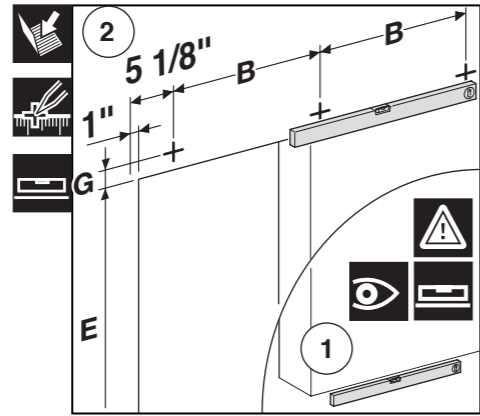

Fig. 8

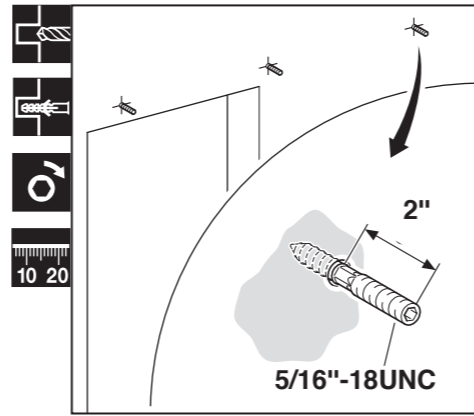

Fig. 9

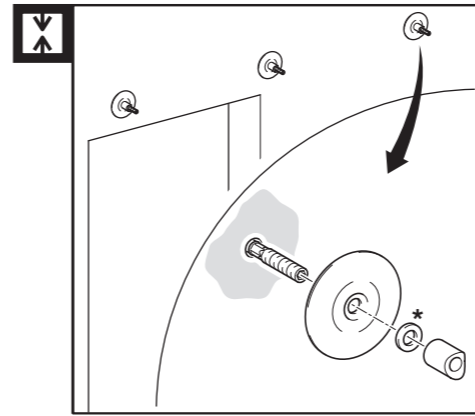

Fig. 10

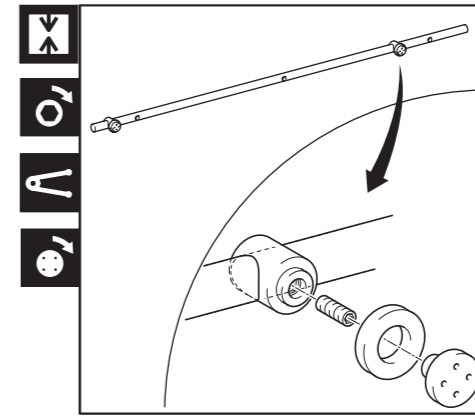

Fig. 11

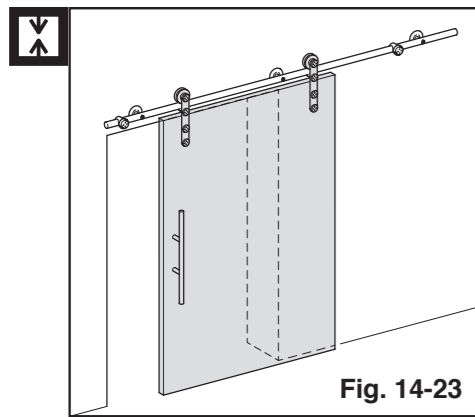
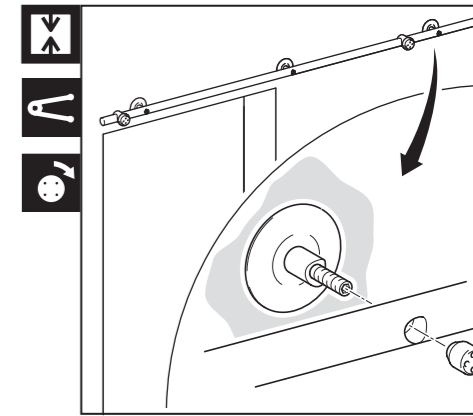

Fig. 13

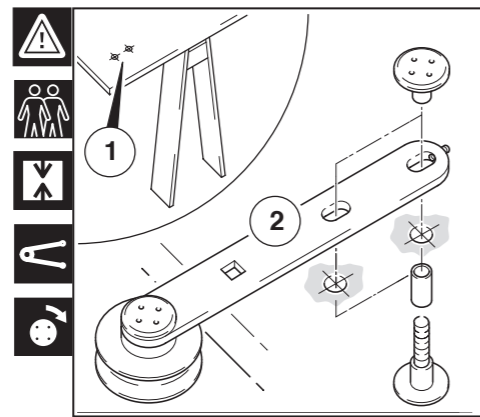

Fig. 14

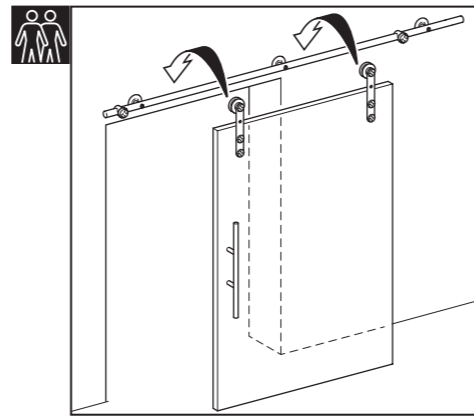

Fig. 15

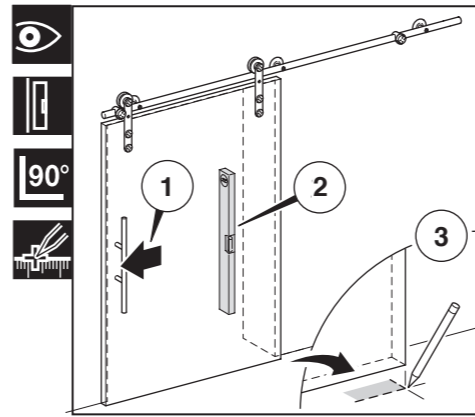

Fig. 16

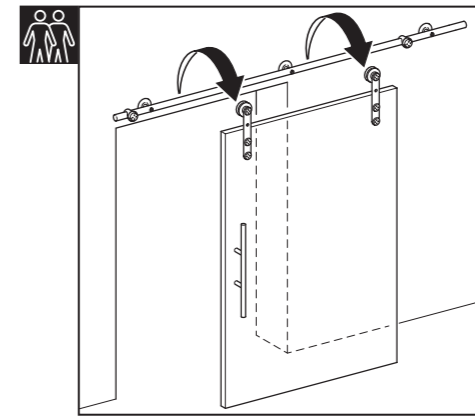

Fig. 17

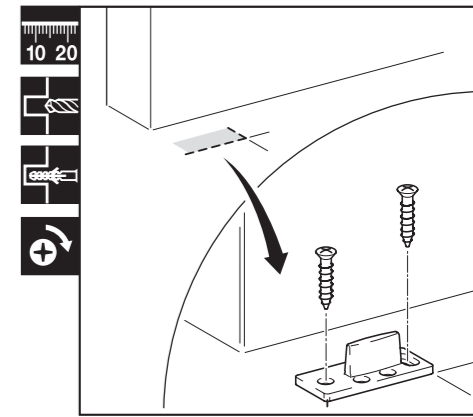

Fig. 18

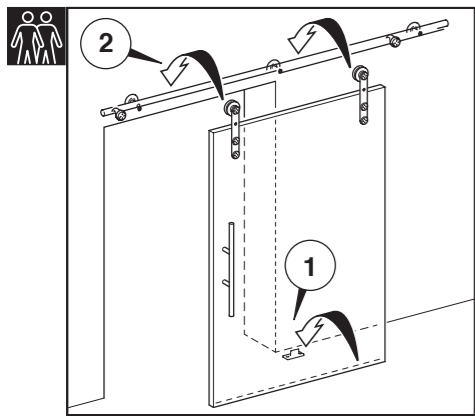

Fig. 19

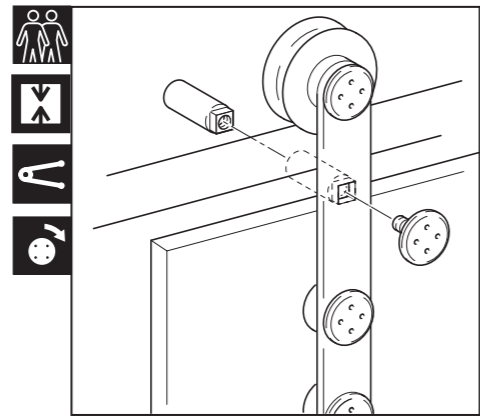

Fig. 20

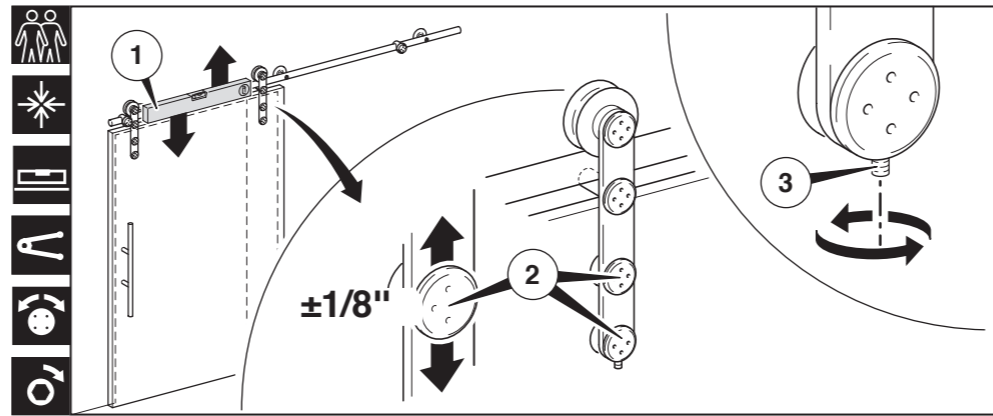

Fig. 21

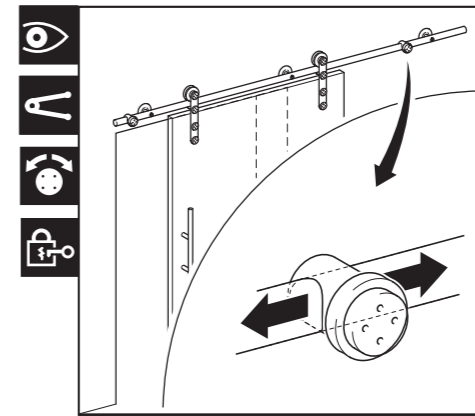

Fig. 22

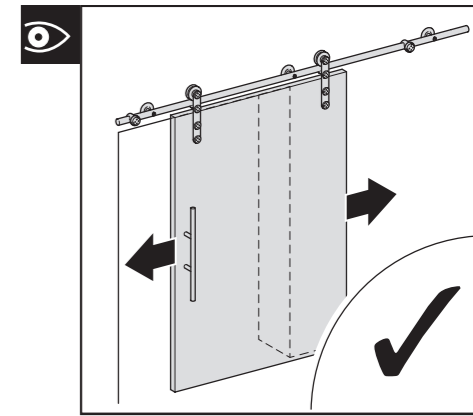
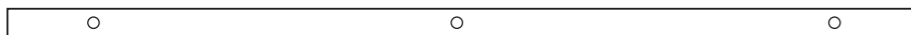

Fig. 23

1 Set sliding door fittings **Flatec I**

2 Guide rail



3 Door stoppers

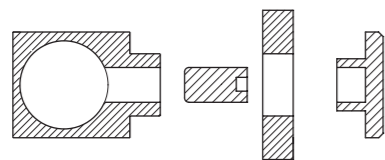

4 Trolley complete

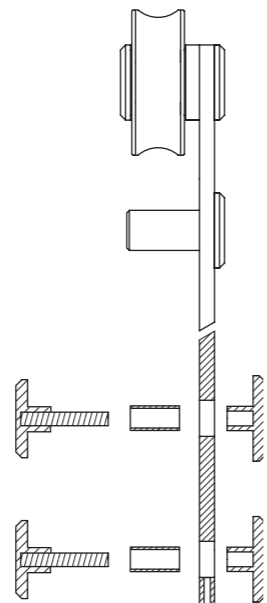

5 Wall fixtures

5/16"-18UNC

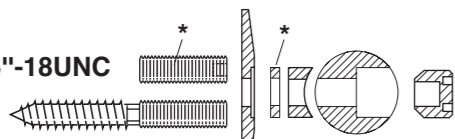

(without screws and dowels, at construction site)
* not included in scope of delivery.

6 Special tool

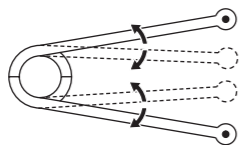

7 Bottom guide

(without screws and dowels, at construction site)

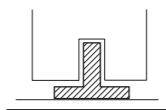

Comply with all general safety regulations when installing the sliding door fittings!

Installation to be completed by qualified licensed contractor.

Be sure to tighten all screw connections one week after starting to use the sliding door fittings!

Never use scouring agents to clean the sliding door fittings; rather use coincommercially available stainless-steel cleaners!



Attention



Screw on



Screw on



Screw on

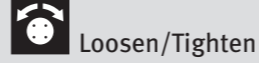

Loosen/Tighten



Install

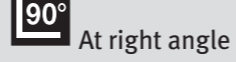

At right angle



Drill



Dowels

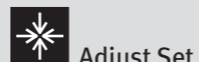

Adjust Set



Level

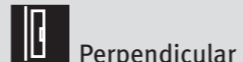

Perpendicular

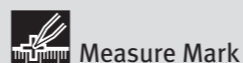

Measure Mark

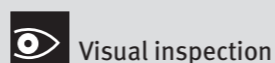

Visual inspection

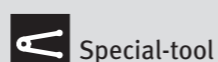

Special-tool

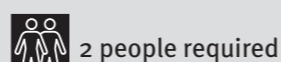

2 people required



Measure

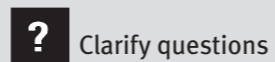

Clarify questions

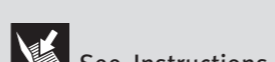

See Instructions



Secure

USU45_Mont_US

Installation instructions

Sliding door fittings Flatec I

for wooden doors (max. 1 3/4" thickness)

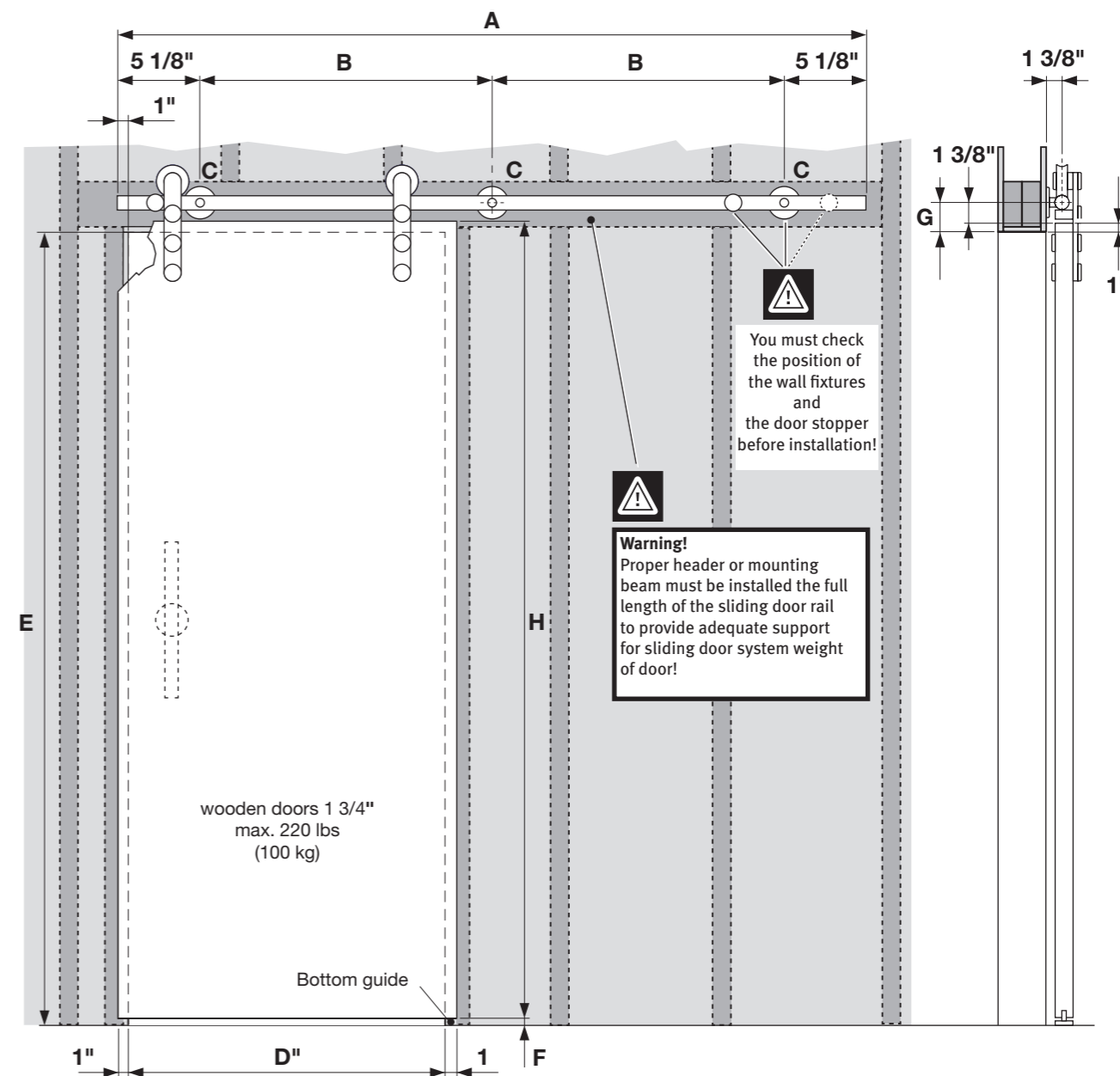

Complete-sets

Set Flatec I Artikel-No.	A inch	B inch	C Each	D inch	E max. inch	F inch	G inch	H max. inch (H=E-F+25)
USU45-1800EF	70 7/8"	30 5/16"	3	29 1/2"-35 7/16"	98 7/16"	1/4"-3/8"	2 3/8"	99 1/8"
USU45-2100EF	82 11/16"	24 1/8"	4	35 13/16"-39 3/8"	98 7/16"	1/4"-3/8"	2 3/8"	99 1/8"
USU45-2300EF	90 9/16"	26 3/4"	4	39 3/4"-44 1/16"	98 7/16"	1/4"-3/8"	2 3/8"	99 1/8"
USU45-2540EF	100"	29 15/16"	4	44 1/2"-49 3/16"	98 7/16"	1/4"-3/8"	2 3/8"	99 1/8"

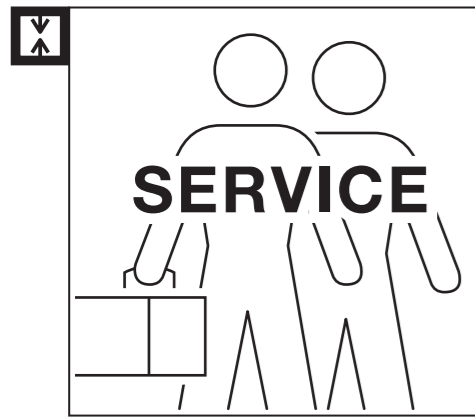

Fig. 1

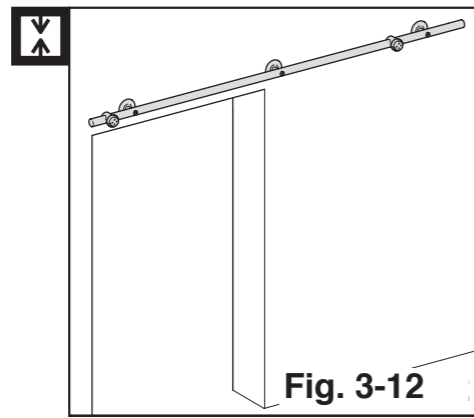

Fig. 2

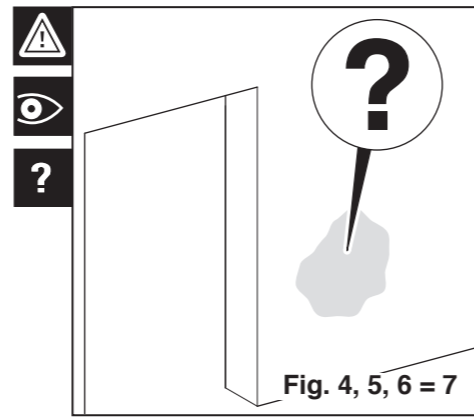

Fig. 3

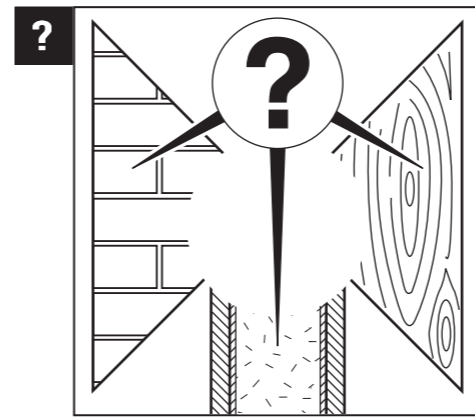

Fig. 4

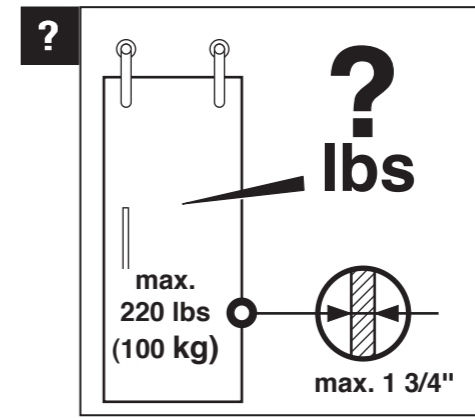

Fig. 5

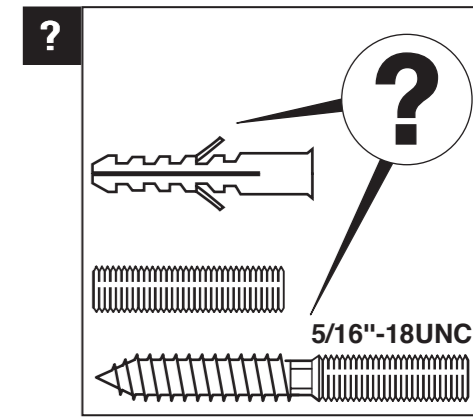

Fig. 6

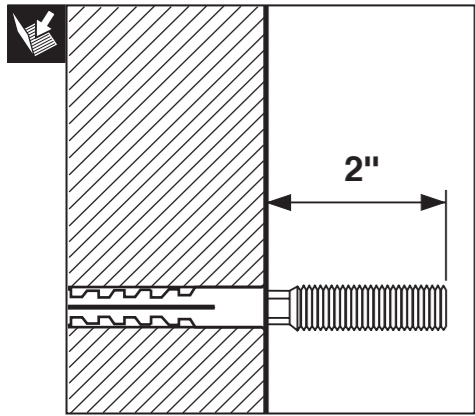

Fig. 7

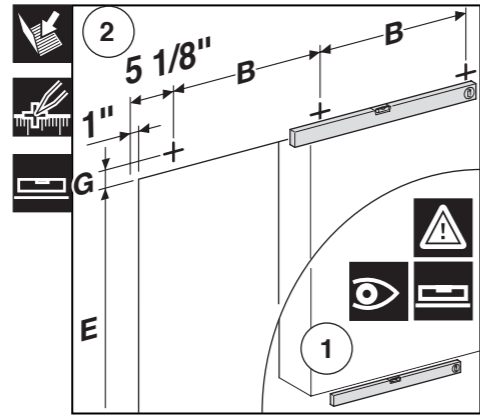

Fig. 8

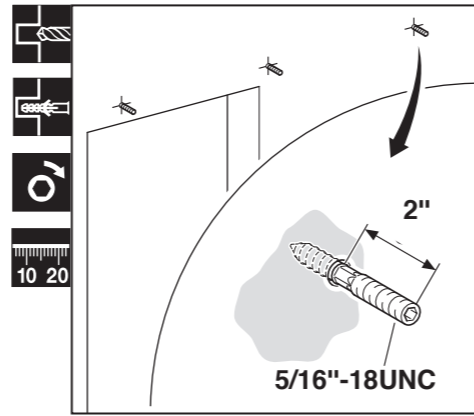

Fig. 9

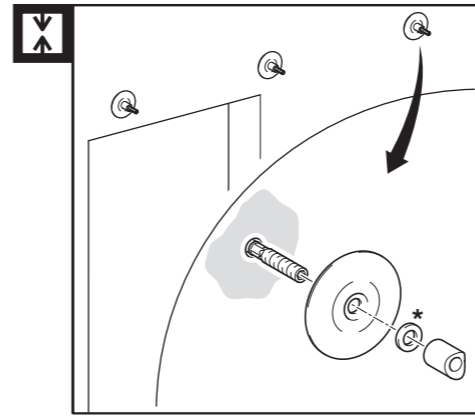

Fig. 10

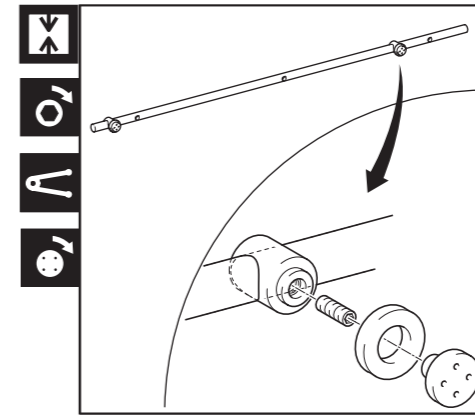

Fig. 11

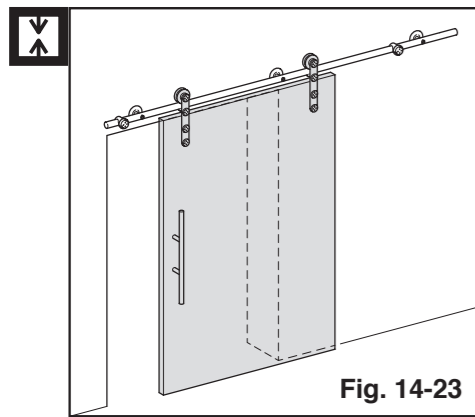
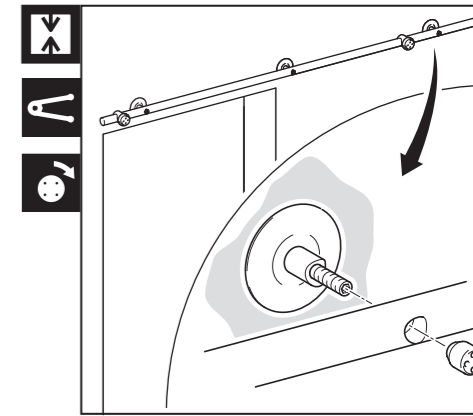

Fig. 13

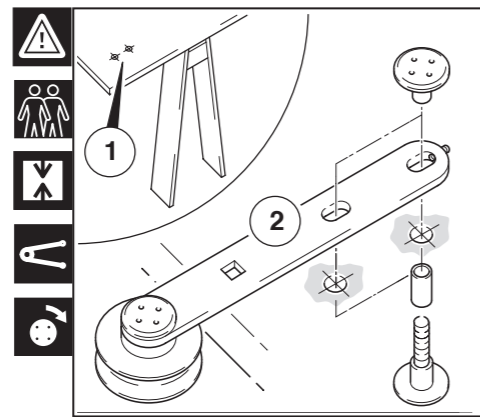

Fig. 14

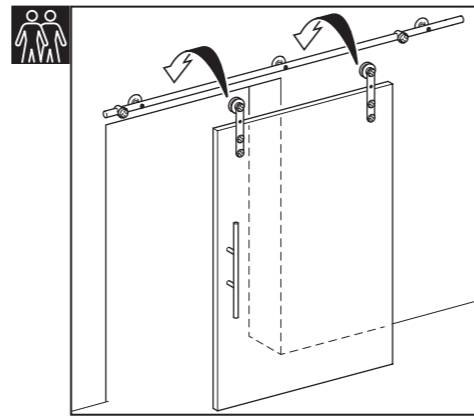

Fig. 15

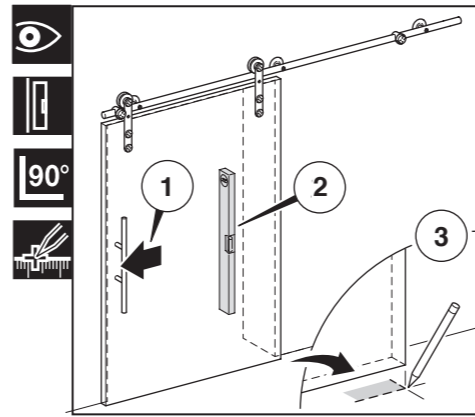

Fig. 16

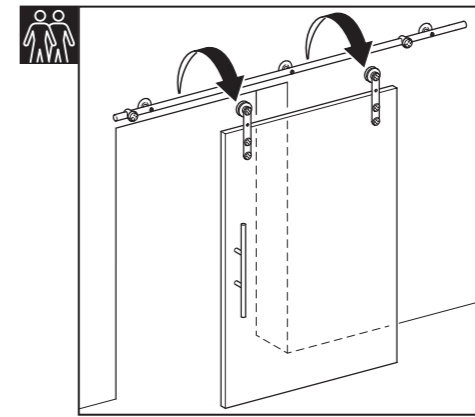

Fig. 17

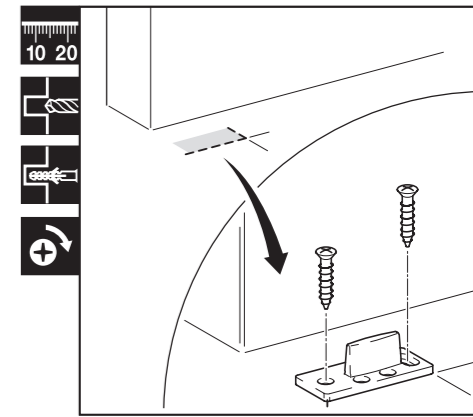

Fig. 18

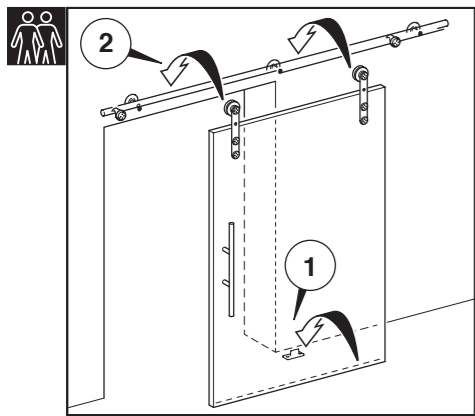

Fig. 19

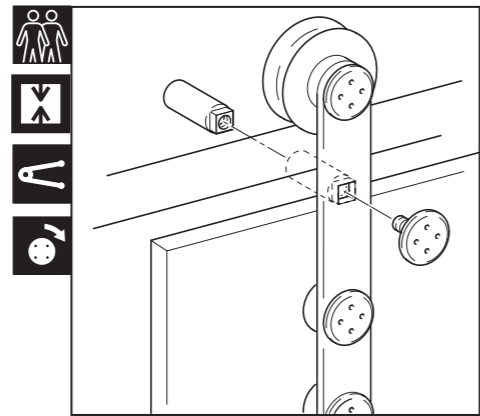

Fig. 20

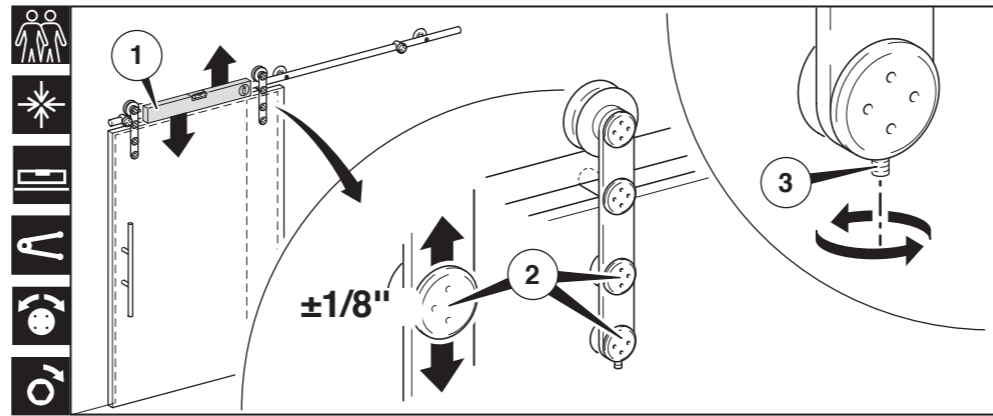

Fig. 21

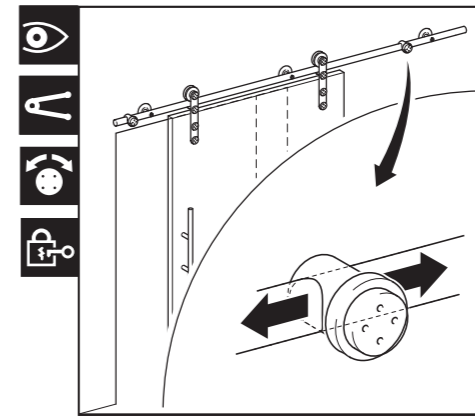

Fig. 22

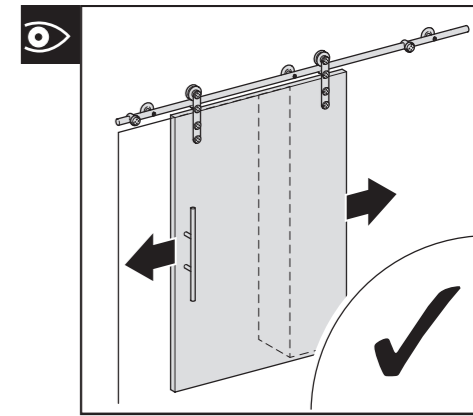

Fig. 23