

INSTALLATION INSTRUCTIONS:

1. INSTALL HARDWOOD CLEATS AGAINST WALL (NOT INCLUDED) IN THE DESIRED POSITIONS MAKING SURE TO FASTEN THEM INTO THE STUDS IN THE EXISTING WALL FOR THE BEST RESULTS AND STRENGTH.
2. BOLT OR SCREW METAL BRACKET TO THE INSTALLED HARDWOOD CLEATS OR WALL DEPENDING ON WHETHER A CLEAT HAS BEEN USED OR NOT. MAKE SURE BRACKET IS SECURELY FASTENED.
3. SLIDE SHELF OVER BRACKET USING PANEL GLUE TO FASTEN SHELF INTO PLACE OR IF A CLEAT HAS BEEN USED THE SHELF CAN BE PIN NAILED INTO THE CLEAT TO LOCK INTO POSITION.

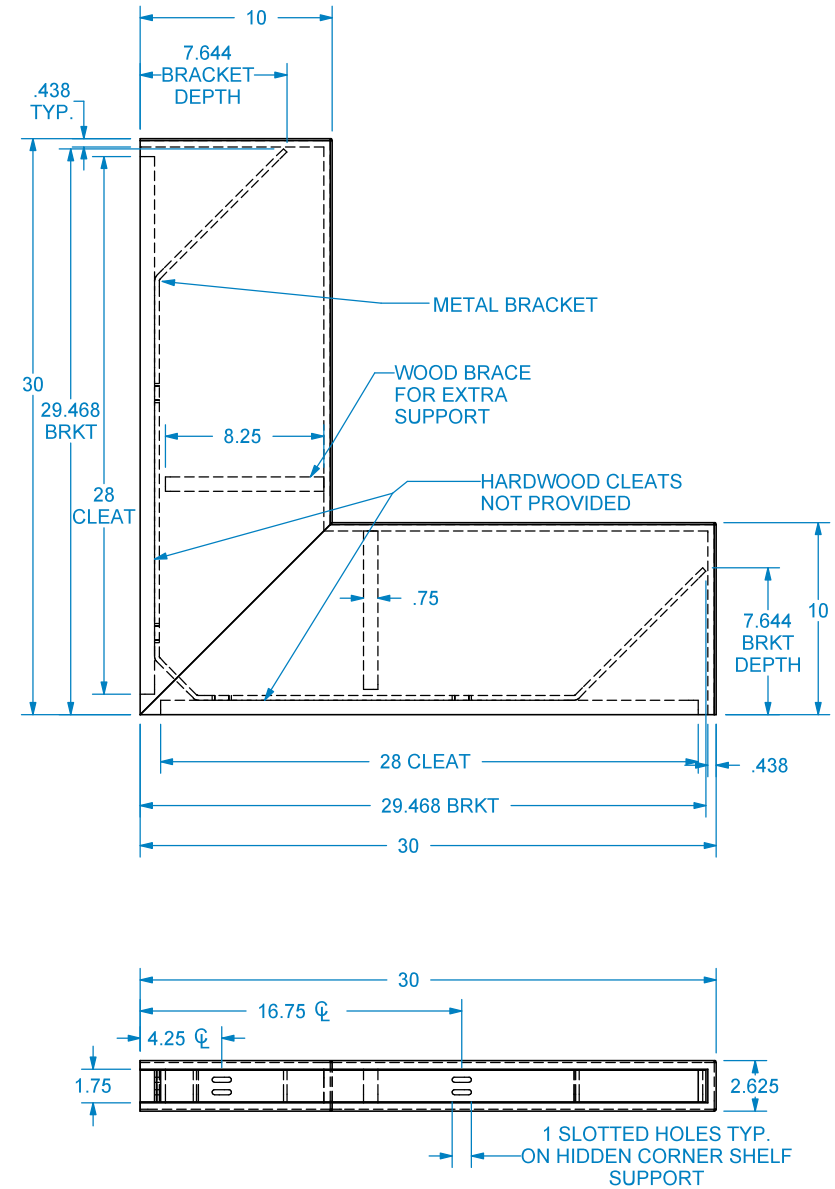
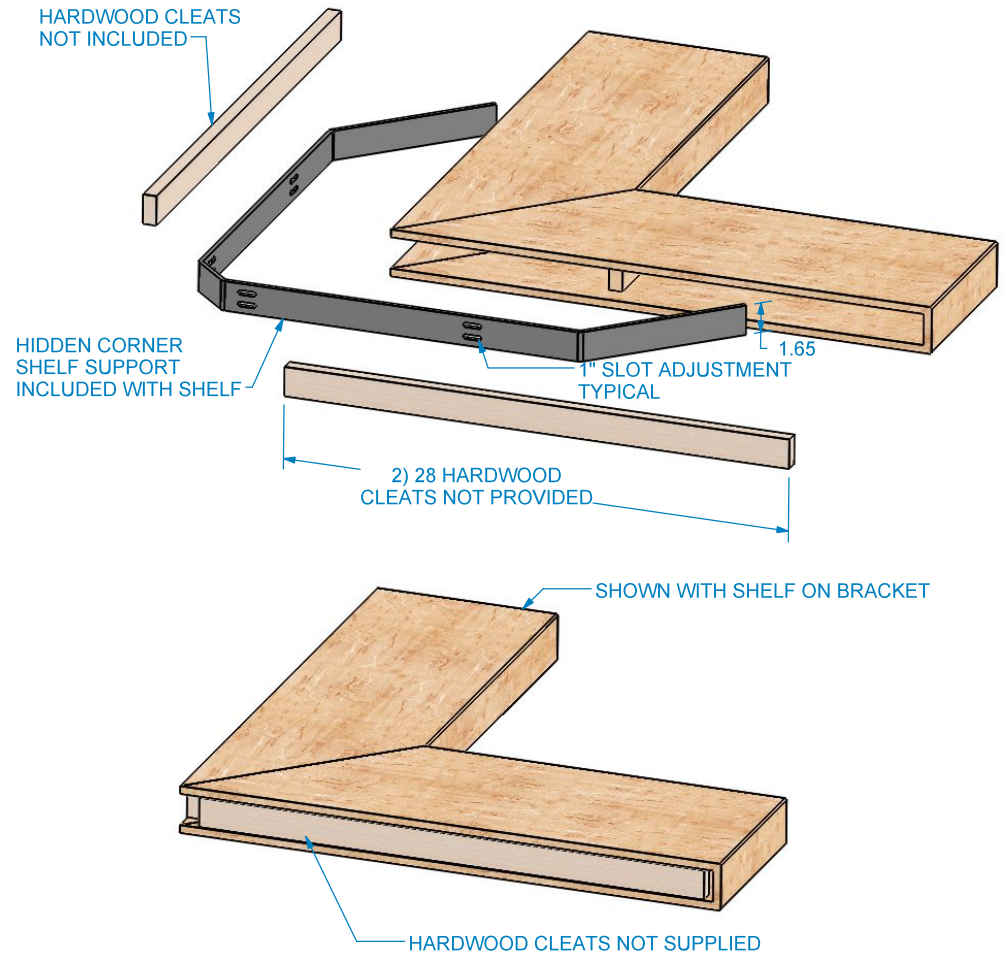

REVISION HISTORY			TOLERANCES		AVAILABLE WOOD SPECIES		
REV	REV DATE	DESCRIPTION	WIDTH	± .03125"	(AK) RED OAK	(AL) ALDER	(CH) CHERRY
A	6-28-2017	CUT DOWN CENTER BRACE TO 8.25"	THICKNESS	± .03125"	(HM) HARD MAPLE	(WL) WALNUT	
			LENGTH	± .0625"	AVAILABLE FINISHES (AKES) RED OAK - ESPRESSO FINISH (AKGR) RED OAK - DRIFTWOOD GREY FINISH (AKAN) RED OAK - ANTIQUE OAK FINISH Do not scale. Use dimensions only. All dimensions are in inches unless noted		
			ANGULAR	± x.x"			
			PROFILE	± x.xxx"			
			Use General Tolerances Unless Noted				

TITLE: 10" X 30" X 30" INDUSTRIAL FLOATING CORNER SHELVES	
NOMINAL SIZE 30" X 30" X 2.625"	
DWG #: 01FL103030-1	REV:
DATE: 6/29/2017	SCALE: 1:10