

BAR BRACKET INSTRUCTIONS

Parts included:

- 2 Wall Bars
- 2 Lower Support Bars
- 2 Small Top Bars
- 2 Plastic Tabs
- 2 #6 x 1-3/4" socket cap screw
- 2 #10 x 1-3/4" flat head phillips mounting screws
- 1 7/32 allen key tool

1) **Choose locations of Bar Brackets**, preferably on wall studs, (see tips on finding studs) and make level marks for screws. (40" max. span between brackets). Brackets should be at least 1.5" to 2" in from each end.

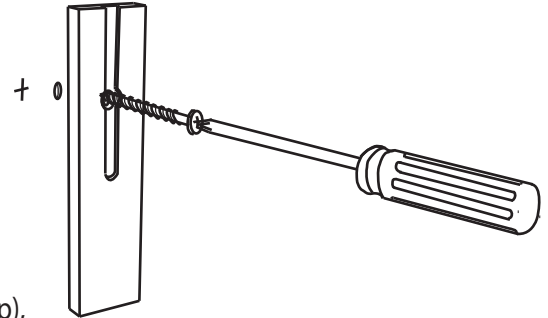

2) Mount Wall Bars .

ON STUD: pre-drill small hole, hold Wall Bar in position (open dovetail slot at top), screw in fastener supplied until tight to wall. (properly installed: supports up to 60lbs)

HOLLOW WALL: Use 3/16"x 3" **FLAT HEAD** toggle bolts (**match head size to screws supplied**). (properly installed: supports up to 50lbs)

CEMENT OR OTHER: Use proper fasteners.

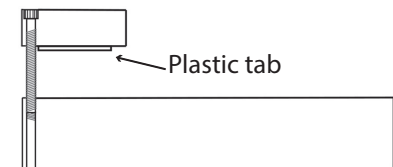

3) Set up & Install Small Top Bar/Support Bar assembly.

SET UP: Put Socket Cap screw through Small Top Bar, (so head fits in recess), thread into the Support Bar (side with threads). Peel & stick plastic tab in place to underside of Small Top Bar, thread in cap screw until space is at shelf thickness +.

INSTALL ASSEMBLY: Carefully slide the set into the dovetail slot of mounted Wall Bar.

4) Put Shelf In Place

Put shelf in place and tighten top cap screw with allen key supplied until tight (do not over tighten).

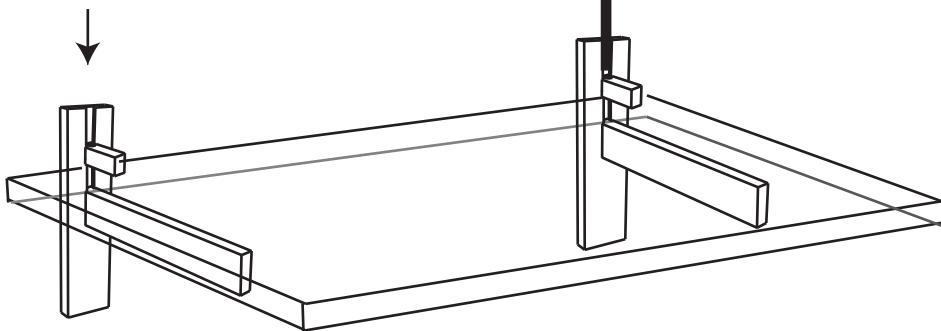
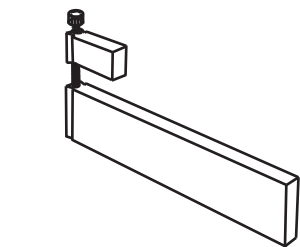

PERFECT SHELVING
SOLUTION:
DISPLAY
BOOKS
KITCHEN & BATH
ENTERTAINMENT EQUIPMENT
CLOSETS & LAUNDRY ROOM
OFFICE
ETC.