

**960 ROCKWELL LEGS | STAINLESS STEEL**

- 2 3/8" (60mm) diameter
- Made of #304 Stainless Steel
- Table, counter and bar heights available
- Quick Install 4 9/16" (116mm) square top mounting plate with M10 threaded bolt for quick attachment to the leg
- 1 1/8" adjustable foot
- Optional decorative foot available
- 220 lbs. weight capacity per leg
- Screws are included
- Can be custom cut down to size
- Sold in Sets of 4 and Single legs

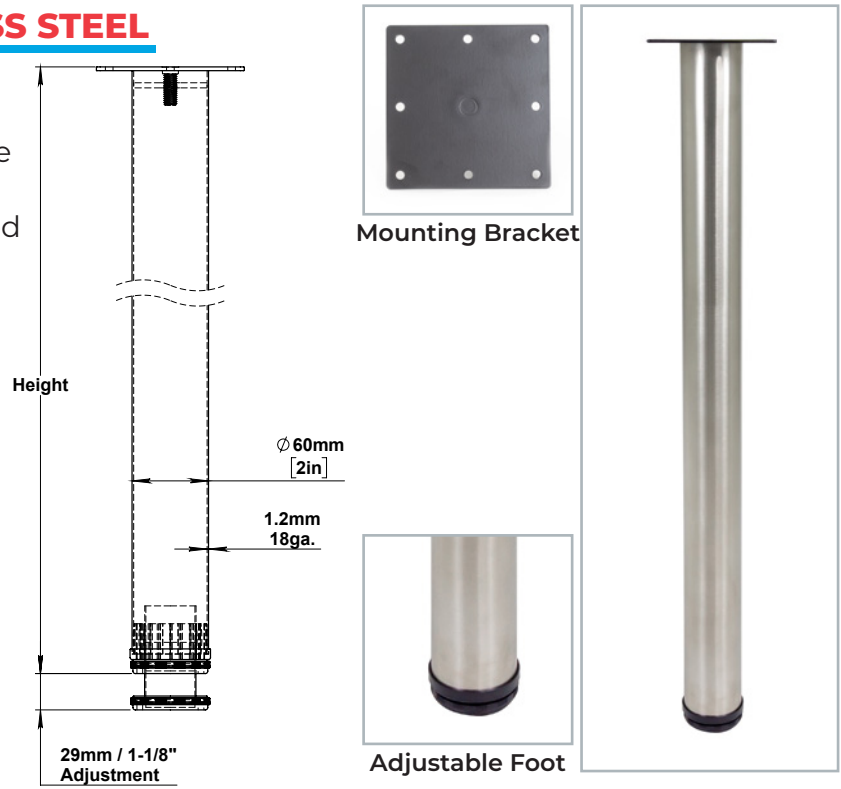

**STAINLESS STEEL FOOT OPTION**

Diagram showing the assembly of a stainless steel leg with a top plate and a decorative foot. The top plate has a threaded insert. The leg is shown with a decorative foot at the bottom.

Top Plate with Threaded Insert

Decorative Foot

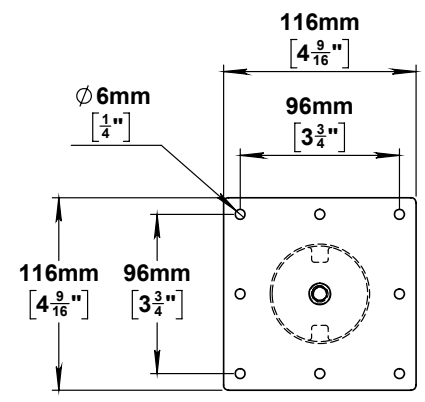

**Table-Height Legs - 28"**

Description	Item No. Set of 4	Item No. Single Leg	Finish
Rockwell 2 3/8" Diameter	960-28-SS	960-7S-SS	#304 Stainless Steel

**Counter-Height Legs - 34 1/2"**

Description	Item No. Set of 4	Item No. Single Leg	Finish
Rockwell 2 3/8" Diameter	960-34-SS	960-8S-SS	#304 Stainless Steel

**Bar-Height Legs - 40 3/4"**

Description	Item No. Set of 4	Item No. Single Leg	Finish
Rockwell 2 3/8" Diameter	960-40-SS	960-1S-SS	#304 Stainless Steel

**Stainless Steel Foot Option**

Description	Item No.
Decorative Foot and Insert	960-DECO-SS