

# STAINLESS STEEL HASP



# HP



HP-40/50  
Rotating eye

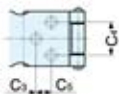

HP-75/100  
Mounting Plate

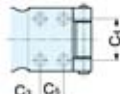

HP-120  
Mounting Plate

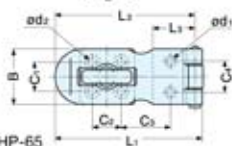
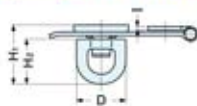

HP-65



Material	Finish
304 Stainless Steel	Polished

Item No.	L <sub>1</sub>	L <sub>2</sub>	L <sub>3</sub>	B	C <sub>1</sub>	C <sub>2</sub>	C <sub>3</sub>	C <sub>4</sub>	C <sub>5</sub>	H <sub>1</sub>	H <sub>2</sub>	C	D	I	d <sub>1</sub>	d <sub>2</sub>	Weight (g)	Box (pcs)	Carton (pcs)
HP- 40	40 (1-37/64")	37	13	22 ( 7/8" )	13	6.4	10.8	12	-	22 ( 55/64" )	17.9	15.3	17.7	1.2	3	3	21.5	30	300
HP- 50	50 (1-31/32")	47		22.3( 7/8" )		9	16					18.3					24	25	250
HP- 65	65 ( 2-9/16" )	62	19	24 ( 15/16" )		13	21.5	14	-			24.5 ( 31/32" )					20.4	24.5	22.5
HP- 75	75 (2-61/64")	72	24.8	27 ( 1-1/16" )	15	15	15.7	16	9.5	27.4 (1-5/64")	22	27.8	23.2	3.8	3.8	51.5	15	150	
HP-100	100 (3-15/16")	95	30	35.5(1-25/64")	19	19	29	21	10	32.2 (1-17/16")	27.9	35.5	31	2	4	4.5	118.5	10	100
HP-120	120 (4-23/32")	115	35.5	40 (1-37/64")	21	22	38	26	15	34.8 ( 1-3/8" )		40.5		2.5	5.2	5.2	172	8	80